

**Aitkin County Land Department Regular Timber Auction**  
 209 2<sup>nd</sup> St. NW Room 206  
 Aitkin, Mn. 56431  
 218-927-7364

Certification #SW-FM/COC-000028

**Tract#: 9**      Township: Salo      Winter Access Only  
 Legal Description: NE1/4 SW¼, S1/2 NE¼, N1/2 SE¼, Sec. 23, Twp. 47, Rge. 22.

|                        |                                   |   |         |                   |
|------------------------|-----------------------------------|---|---------|-------------------|
| ASPEN P/B              | 350.00 Cords                      | @ | 18.00 = | 6300.00           |
| * BALSAM FIR P/B       | 30.00 Cords                       | @ | 18.00 = | 540.00            |
| + MAPLE P/B            | 45.00 Cords                       | @ | 8.00 =  | 360.00            |
| P BIRCH P/B            | 215.00 Cords                      | @ | 9.50 =  | 2042.50           |
| <b>Total Acres =24</b> | <b>Sale expires May 15, 2015.</b> |   |         | <b>\$9,242.50</b> |

Sale Administrator: Tom Parkin

**Down Payment Required: \$1,386.38**

/// Area to be clearcut except for oak, ash, and basswood. Reserve den and snag trees when possible. Snowmobile regs apply during season. Sale crosses ATV trail no debris left on trail and skid across designated spot. Landing approved by forester. No cutting from 3-15 to 12-1 unless approved by forester. Aspen and birch sold on scale. All else sold on area estimate.

**PERMIT # 13299**

UTM Coordinates  
 N 5154334  
 E 493673

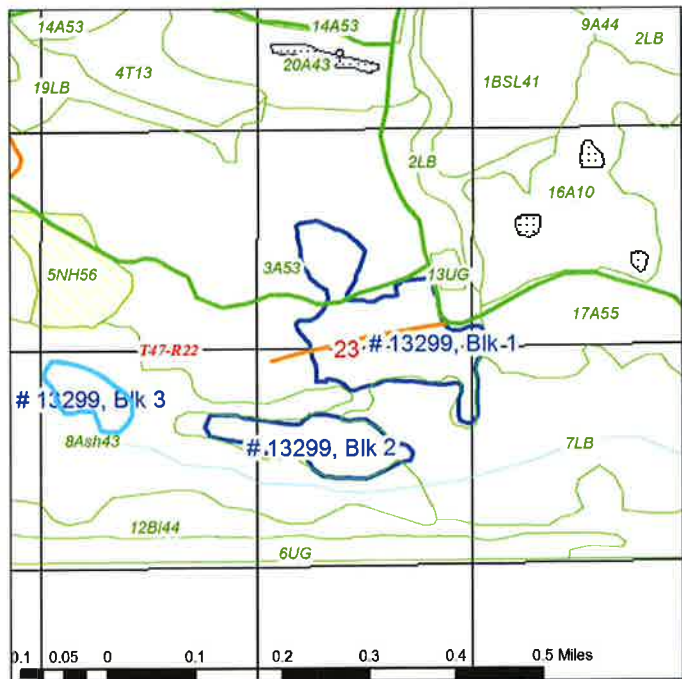

\*\*\*\* Purchaser \_\_\_\_\_ Bid Up \_\_\_\_\_ \*\*\*\*

*Species Code*

+ Sold area estimate, \* Non-bid, area estimate, # Non-bid, scale    Blank: Bid, scale