

Aitkin County Land Department  
209 2<sup>nd</sup> St. NW Room 206  
Aitkin, Mn. 56431  
218-927-7364

Certification #SW-FM/COC-000028

Regular Sealed Bid Auction

**Tract#: 22** Township: Unorganized - Lemay Summer Access  
Legal Description: SE<sup>1</sup>/<sub>4</sub> SE<sup>1</sup>/<sub>4</sub>, SE<sup>1</sup>/<sub>4</sub> SW<sup>1</sup>/<sub>4</sub>, NW<sup>1</sup>/<sub>4</sub> SW<sup>1</sup>/<sub>4</sub>, NE<sup>1</sup>/<sub>4</sub> SW<sup>1</sup>/<sub>4</sub>, Sec. 2, SW<sup>1</sup>/<sub>4</sub> NE<sup>1</sup>/<sub>4</sub>, N<sup>1</sup>/<sub>2</sub> SE<sup>1</sup>/<sub>4</sub>, Sec. 3, NW<sup>1</sup>/<sub>4</sub> NW<sup>1</sup>/<sub>4</sub>, Sec. 11, Twp. 51, Rge. 27.

R/W PINE P/B	% Bolts: 15	370.00 Cords	@	20.25 =	7492.50
W SPRUCE P/B		70.00 Cords	@	18.00 =	1260.00

Total Acres = 21 \$8,752.50

Sale Administrator: Dan Gordon 36 month sale.

**Down Payment Required: \$1,312.88**

/// Shaded area to be cut. (Block 1) - 12' to 14' spacing between crop trees. (Blocks 2- 5) - 14' to 17' spacing between crop trees. No damage to remaining trees. Utilize to a 4" top. No harvesting from 3-15 to 7-1 unless approved by forester. Sold subject to scale. Pre-harvest meeting required - crop tree specification to be determined by forester.

**PERMIT # 13131**

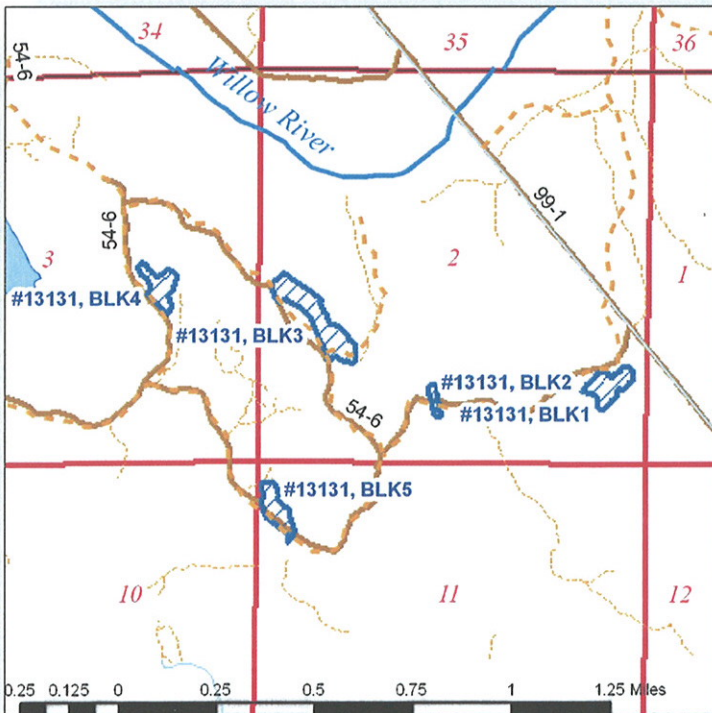

GPS Coordinates – UTM  
N 5197249  
E 443648

\*\*\*\* Purchaser \_\_\_\_\_ Bid Up \_\_\_\_\_ \*\*\*\*

Species Code

+ Sold area estimate, \* Non-bid, area estimate, # Non-bid, scale Blank: Bid, scale