

Aitkin County Land Department Regular Timber Auction

209 2nd St. NW Room 206

Aitkin, Mn. 56431

218-927-7364

Certification #SW-FM/COC-000028

Tract#: 19 Township: Lee

Winter Access Only

Legal Description: SE¼, Sec. 24, NE¼, SE¼ NW¼, Sec. 25, Twp. 46, Rge 24.

ASH P/B	244.00 Cords	@ 11.30 =	2757.20
* ASPEN P/B	6.00 Cords	@ 18.00 =	108.00
* BASSWOOD P/B	64.00 Cords	@ 11.30 =	723.20
+ MAPLE P/B	90.00 Cords	@ 8.00 =	720.00
+ OAK P/B	71.00 Cords	@ 22.77 =	1616.67
* P BIRCH P/B	18.00 Cords	@ 14.28 =	257.04

Total Acres =65 Expires March 15, 2015 \$6,182.11

Sale Administrator: Tom Parkin

Down Payment Required: \$927.32

Block 2 /// Area to be select cut. Cut trees marked in orange. # Block 1 and 3 Area to

be select cut. There are 12 clearcut patches in Block #1 and 19 clearcut patches in Block#3. Each patch is an 80' radius clearcut except for conifers and yellow birch. The center of each is marked with an orange tree. No full tree skidding. No damage to residuals. Snowmobile regulations apply during season. No cutting from 3-15 to 12-1 unless approved by forester. Ash sold on scale all others sold on area estimate.

PERMIT # 12970

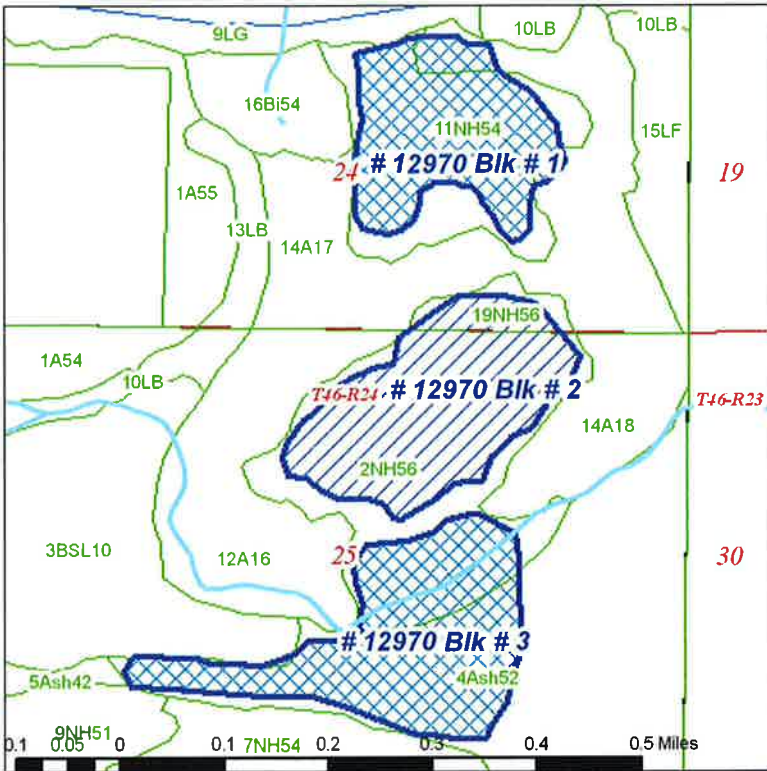

12970: UTM Coordinates
N 5143663
E 476107

**** Purchaser _____ Bid Up _____ ****

Species Code

+ Sold area estimate, * Non-bid, area estimate, # Non-bid, scale Blank: Bid, scale