

**Aitkin County Land Department Regular Timber Auction**  
 209 2<sup>nd</sup> St. NW Room 206  
 Aitkin, Mn. 56431  
 218-927-7364

Certification #SW-FM/COC-000028

**Tract#: 17**    Township: Beaver    Winter Access Only  
 Legal Description: W½ NW¼, Sec. 13, Twp. 46, Rge 22.

ASPEN P/B	290.00 Cords	@ 18.00 =	5220.00
+ BALSAM FIR P/B	20.00 Cords	@ 18.00 =	360.00
+ MXD HWD P/B	65.00 Cords	@ 8.00 =	<u>520.00</u>
<b>Total Acres = 16</b>	<b>Expires March 15, 2015</b>		<b>\$6,100.00</b>

Sale Administrator: Tom Parkin

*Down Payment Required: \$915.00*

/// Area to be clearcut except for oak. Reserve den and snag trees when possible. No cutting from 3-15 to 12-1 unless approved by forester. Stay out of reserve patch in north block. Aspen sold on scale all else sold on area estimate.

**PERMIT # 13226**

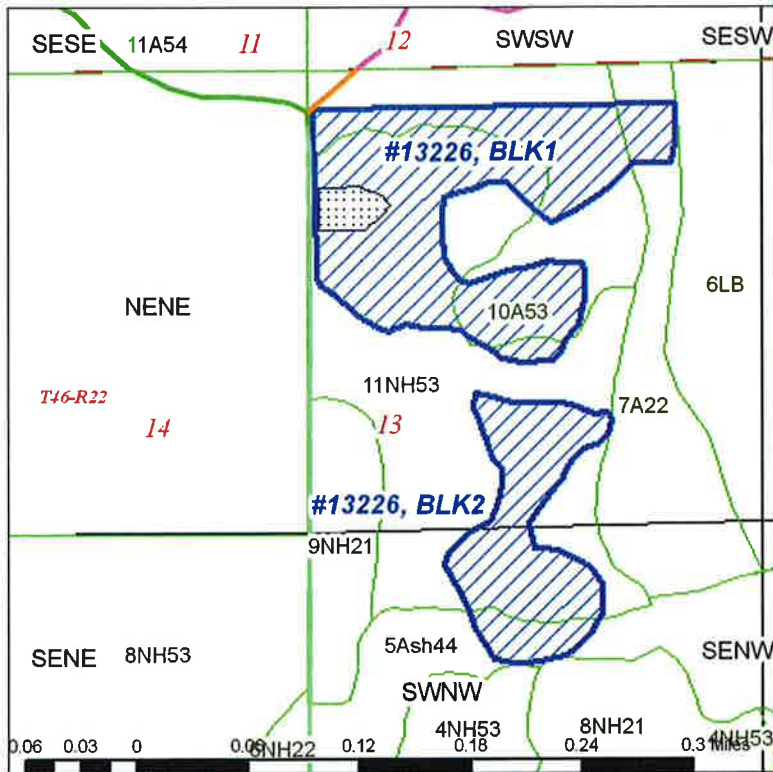

13226: UTM Coordinates	
N	5146955
E	494248

\*\*\*\* Purchaser \_\_\_\_\_ Bid Up \_\_\_\_\_ \*\*\*\*

*Species Code*

+ Sold area estimate, \* Non-bid, area estimate, # Non-bid, scale    Blank: Bid, scale