

Aitkin County Land Department Regular Timber Auction
 209 2nd St. NW Room 206
 Aitkin, Mn. 56431
 218-927-7364

Certification #SW-FM/COC-000028

Tract#: 11 Township: Lakeside Winter Access Only
 Legal Description: S½ NE¼, N½ SE¼, S½ SE¼, Sec. 17, Twp. 44, Rge 25.
 ASH P/B 1000.00 Cords @ 22.00 = 22000.00
 Total Acres = 110 Expires March 15, 2015 \$22,000.00
 Sale Administrator: Bob Kangas

Down Payment Required: \$3,300.00

/// Select cut. Fifty-five 160 ft. diameter circles (one-half acre) are to be clearcut patches throughout the stand. Plot center of each harvest circle is marked in orange. Birch and elm are to be reserved. No stumps left >12" high. Skid trails are to be approved by forester. Operating to be done under frozen conditions only. Sold on scale. Approx 5% veneer and 30% bolts.

PERMIT # 13094

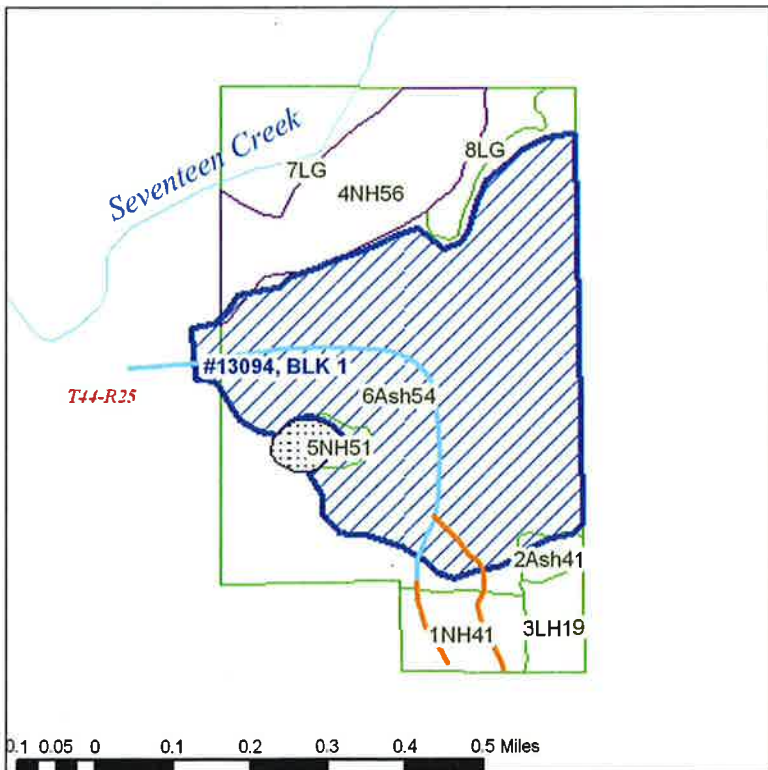

13094: UTM Coordinates	
N	5127085
E	460003

**** Purchaser _____ Bid Up _____ ****

Species Code

+ Sold area estimate, * Non-bid, area estimate, # Non-bid, scale Blank: Bid, scale