

Aitkin County Land Department Regular Timber Auction

209 2nd St. NW Room 206

Aitkin, Mn. 56431

218-927-7364

Certification #SW-FM/COC-000028

Tract#: 1 Township: Wagner Winter Access Only
 Legal Description: NW¼ NE¼, SE¼ NW¼, SW¼ NE¼, Sec. 4, Twp. 43, Rge 22.

ASH P/B	50.00 Cords	@ 8.00 =	400.00
ASPEN P/B	30.00 Cords	@ 18.00 =	540.00
BASSWOOD P/B	45.00 Cords	@ 8.00 =	360.00
MAPLE P/B	440.00 Cords	@ 8.00 =	<u>3520.00</u>

Total Acres =37 Expires March 15, 2015 **\$4,820.00**

Sale Administrator: Bob Kangas

Down Payment Required: \$723.00

/// All aspen to be cut. /// Select cut. Cut only maple, aspen, ash, and basswood. Leave a large diameter quality hwd tree as defined by forester, approximately every forty feet. No damage to remaining trees. Utilize to a 4" top. No cutting from 3-15 to 12-1 unless approved by forester. Sold on scale.

PERMIT # 13171

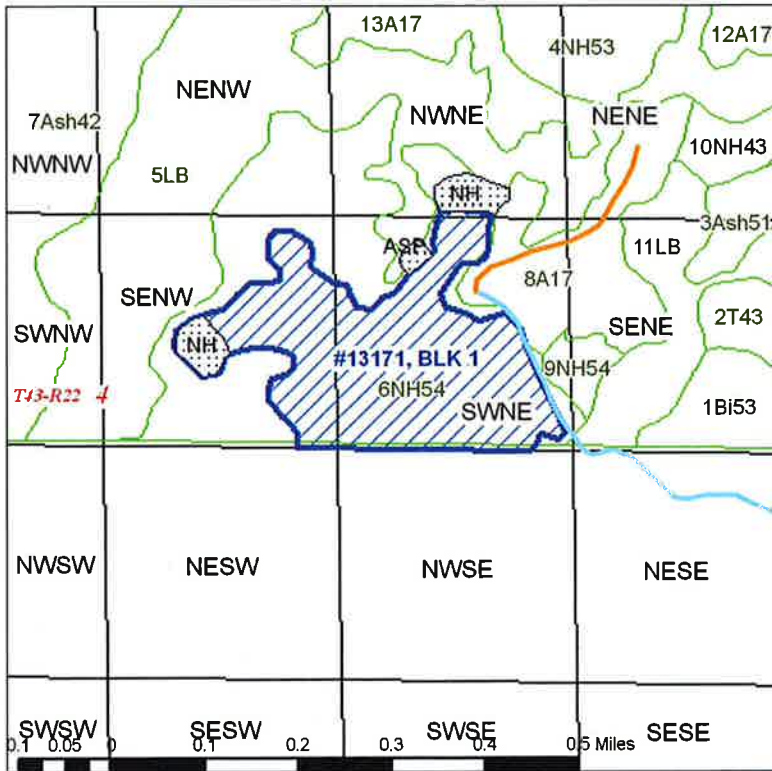

13171: UTM Coordinates	
N	5120628
E	490289

**** Purchaser _____ Bid Up _____ ****

Species Code

+ Sold area estimate, * Non-bid, area estimate, # Non-bid, scale Blank: Bid, scale